

# Blok Desk in Brass

With a minimal aesthetic, the elegant lines and angles of the **Blok** range of reception desks are specified for office and reception spaces of all sizes, from a selection of modular components which are installed as one highly finished piece. Available as part of the Isomi in Metal collection in lacquered hot rolled steel, copper and brass, the desks are perfectly suited to contemporary public spaces and reception environments.

## Key features

Easy to specify modular components

Three height options of 30", 37.5" and 43.5" as standard

CAD and BIM files available

Illuminated branding, sign-in platform and storage units available as options

Reception desks can be handed to the left or right

DDA modules available

Inset black matt laminate worktop, LED light trough and cable management included as standard

Made in authentic, hand-selected hot rolled steel, copper and brass

Available in 6–8 weeks (UK), 12–14 weeks (US)



---

## Blok Desk in Brass Modules

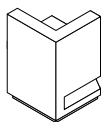

**BD01**  
Left End  
W31.5  
D34.5  
H30/37.5/43.5"

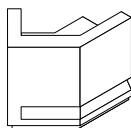

**BD02**  
Left End Angle 45°  
W34.5  
D34.5  
H30/37.5/43.5"

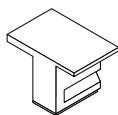

**BD03**  
Left End DDA  
W31.5  
D46.25  
H30"

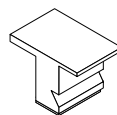

**BD04**  
Straight DDA  
W31.5  
D46.25  
H30"

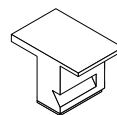

**BD05**  
Right End DDA  
W31.5  
D46.25  
H30"

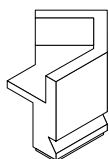

**BD06**  
Right End Angle 45°  
W34.5  
D34.5  
H30/37.5/43.5"

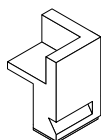

**BD07**  
Right End  
W31.5  
D34.5  
H30/37.5/43.5"

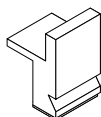

**BD08**  
Straight  
W31.5  
D34.5  
H30/37.5/43.5"

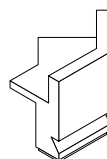

**BD09**  
Angle 45°  
W34.5  
D34.5  
H30/37.5/43.5"

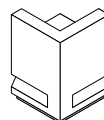

**BD10**  
Angle 90°  
W34.5  
D34.5  
H30/37.5/43.5"

---

## Accessories

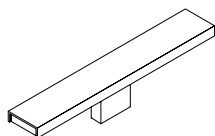

**Blok**  
Sign-in platform/light  
Powder coated aluminium  
W60  
D10  
H13.75"



**TB**  
Translucent branding  
W31.5  
H8"  
(recommended dimensions)



**LS**  
LED skirting

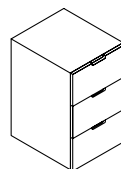

**DU**  
Drawer unit  
W15.75  
D10/20.5  
H27.5"

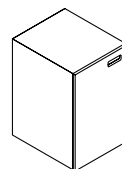

**CU**  
Cupboard unit  
W15.75  
D10/20.5  
H27.5"

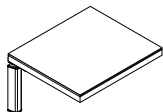

**Electric sit-stand desk**  
H25.5-37.5"  
D23.5-118"

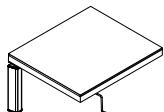

**Manual sit-stand desk**  
H25.5-37.5"  
D23.5-118"



**Infrared heating panel**





**Blok Desk in Brass  
Configurations**



**Configuration 1**

W63  
D34.5  
H30/37.5/43.5"



**Configuration 2**

W94.5  
D34.5/46.25  
H30/37.5/43.5"



**Configuration 3**

W94.5  
D34.5  
H30/37.5/43.5"



**Configuration 4**

W126  
D34.5/46.25  
H30/37.5/43.5"



**Configuration 5**

W157.5  
D34.5/46.25  
H30/37.5/43.5"

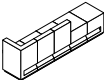

**Configuration 6**

W189  
D34.5/46.25  
H30/37.5/43.5"

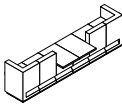

**Configuration 7**

W107.5  
D34.5/46.25  
H30/37.5/43.5"



**Configuration 8**

W62.75/62.75  
D34.5  
H30/37.5/43.5"



**Configuration 9**

W94.5/62.75  
D34.5/46.25  
H30/37.5/43.5"

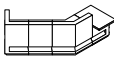

Illustrations above relate to the product at 37.5" height.



**Configuration 10**

W97.5/97.5  
D34.5  
H30/37.5/43.5"

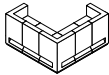

**Configuration 11**

W97.5/97.5  
D34.5/46.25  
H30/37.5/43.5"

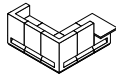

---

**Blok Palette**

**Metal**



Hot Rolled Steel  
M001



Brass  
M002



Copper  
M003

---

Alternative colours are available on request. For a full list of colour options please download our colour chart. The printed representation of colours may vary from actual samples. Always request actual samples before ordering.

---